

Soils Map

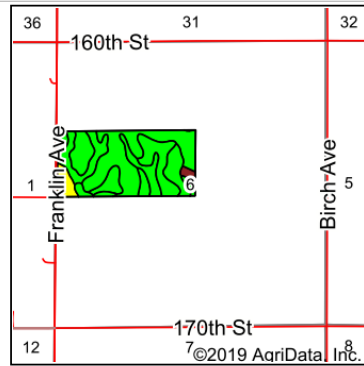

State: **Iowa**
 County: **Butler**
 Location: **6-92N-18W**
 Township: **Pittsford**
 Acres: **83.51**
 Date: **2/19/2020**

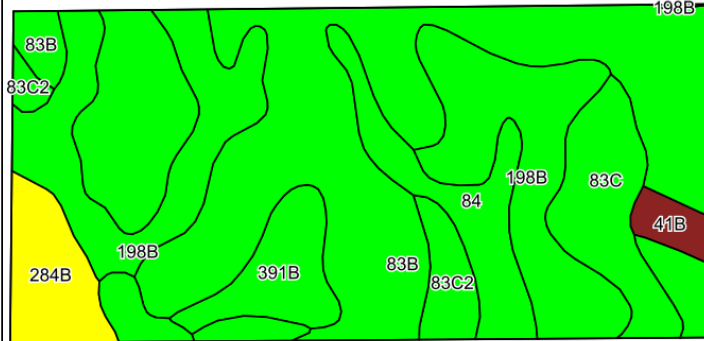

Maps Provided By:
surety
CUSTOMIZED ONLINE MAPPING
© AgriData, Inc. 2019 www.AgriDataInc.com



©2019 AgriData, Inc.

Soils data provided by USDA and NRCS.

Area Symbol: IA023, Soil Area Version: 25

Code	Soil Description	Acres	Percent of field	CSR2 Legend	Non-Irr Class *c	Irr Class *c	CSR2**	CSR	Alfalfa hay	Bromegrass alfalfa	Bromegrass alfalfa hay	Canarygrass hay	Corn	Corn silage	Kentucky bluegrass	Oats	Smooth bromegrass	Soybeans
83B	Kenyon loam, 2 to 5 percent slopes	37.69	45.1%	■	Ile		90	85		11	6.6		210		3.9	91	6.6	61
198B	Floyd loam, 1 to 4 percent slopes	19.72	23.6%	■	IIw		89	75										
84	Clyde silty clay loam, 0 to 3 percent slopes	6.76	8.1%	■	IIw		88	75	4.4	7	4.2	3	193.5	18	3.3	76.5	6.3	56
83C	Kenyon loam, 5 to 9 percent slopes	6.02	7.2%	■	IIIe		85	70		10.6	6.4		188		3.7	90.5	6.2	48.5
284B	Flagler sandy loam, 2 to 5 percent slopes	4.33	5.2%	■	IIIe		51	50										
391B	Clyde-Floyd complex, 1 to 4 percent slopes	4.17	5.0%	■	IIw		87	72										

Soils data provided by USDA and NRCS.

Maps Provided By:



© AgriData, Inc. 2019 www.AgriDataInc.com

Code	Soil Description	Acres	Percent of field	CSR2 Legend	Non-Irr Class *c	Irr Class *c	CSR2**	CSR	Alfalfa hay	Bromegrass alfalfa	Bromegrass alfalfa hay	Canarygrass hay	Corn	Corn silage	Kentucky bluegrass	Oats	Smooth bromegrass	Soybeans
83C2	Kenyon loam, 5 to 9 percent slopes, eroded	3.54	4.2%		IIIe		84	68		10.6	6.3		212		3.7	88	6.2	61
41B	Sparta loamy fine sand, 2 to 5 percent slopes	1.28	1.5%		IVs	Ile	39	40										
Weighted Average							86	76.9	0.4	6.7	4	0.2	133	1.5	2.5	57.5	4.2	38.1

**IA has updated the CSR values for each county to CSR2.

*c: Using Capabilities Class Dominant Condition Aggregation Method